

# ULTRA CATALOG



**4–way**

4–way feature end frame	34
hardware	34
metal top panel	34
perf back panel	34
shelves	34
solid back panel	34
wood base	34

**accessories**

base bulkhead	36
center bottom arm tie down	39
cover plate	36
cross bar	41
end bottom arm tie down	39
flange bracket	41
glides	36
hang rod components	41
heavy duty wallmount standard	37
leveler	36
standard wall tie bracket	39
super structure locking key	37
super structure post	37
super structure u bar	37
top cap anchor bracket	39
top cap bracket	36
touch–up paint	41
upright & bottom arm tie down	39
wallmount standard	37

**back panels**

perf, 4–way	34
perf, extender	26
perf, feature end frame	33
perf, gondola	25
slatwall, extender	26
slatwall, feature end frame	33
slatwall, gondola	25
solid, 4–way	34
solid, bottle bay	46
solid, extender	26
solid, feature end frame	33
solid, gondola	25
square cut	25

**back room**

back room system	55
------------------	----

**base components**

base nose	24
base nose end cap	24
electrical floating kick plate	24
floating kick plate	24
flush base	24
	24

**bottle bay**

bottle bay	45
double bottom	46
double end panel	46
double top	46
hardware pack	48
overlay end panels	48
shelves	48
single back brace	47
single base cover	47
single bottom	47
single end panel	47
single top	47
solid back panels	46

**bottom arms & decks**

center bottom arm	22
deck	22
end bottom arm	22

**caster components**

brace	38
caster	38
channel	38
hardware	38

**contour end base**

contour end base	30
------------------	----

**cornice**

metal front	40
metal return	40
metal shelf mount bracket	40
telescoping bracket	40

## cross components

cross tie	23
replacement top cap	23
slatwall tie bar	23
tie bar	23
top cap	23

## feature end frame

bottom angle	32
feature end frame	31
hardware	32
perf back panel	33
side rail	32
sign stem fitting	32
slatwall back panel	33
solid back panel	33
t-brace	31
top channel	32

## gondola standards

center standard	21
end standard	21
extender standard	21

## information

base & extender standard assembly	20
color information	8
customer directed move-outs	9
exploded gondola & wallcase	18
gondola & wallcase component specifications	12-17
open back components	19
terms & conditions of sale	7
unbalanced load calculations	10
unbalanced load ratings	11

## outrigger & widespan

outrigger	55
widespan	56

## security case components

glass door assembly	35
metal end panels	35
hardware	35

## shelving options

3" wire fencing	28
basket/shelf brackets	29
book shelf adapter	28
endless wire basket	29
glass shelf	29
product retainer	28
reversible wire shelf	29
shelf key	28

## standard & heavy duty shelves

heavy duty shelf	27
standard shelf	27

## under counter cabinets

3 drawer locked narcotics	53
3 drawer vial/bottle	52
4 drawer accessory	50
5 drawer accessory	51
5 drawer RX	53
adjustable shelf	54
back splash	54
basic open	49
counter top	54
drawer & half door	50
dual shelf	49
half modular	52
high rise end panel	54
locked drawer	50
over sink	53
printer	51
printer pullout	52
sink	51
waste	49

**WireFlex™**

akro bin	44
base deck	43
island	42
monitor tray	44
reinforced cross bar	44
shelf	43
speedwall	43
telephone tray	44
tray divider	44
vial cap bin	44
wall	42
wallmount standard	43



**Price and Acceptance:** Streater reserves the right to change its prices and other terms and/or conditions of sale without notice. All orders placed shall be in writing and become effective only upon acceptance by Streater at its offices in Albert Lea, MN. Streater at its discretion may add handling charges depending on order size and/or order requirements.

**Taxes:** Buyer agrees to pay all taxes which Streater may be required to assess. If buyer claims a tax exempt status, buyer will provide Streater with a valid tax-exemption certificate.

**Payment Terms:** Payment to Streater will be cash with order or net 30 days to qualified buyers, upon approval by Streater Credit Department. Overdue payments will be assessed interest charges at the legal rate of the State of Minnesota or the state of the buyer's residence, whichever is greater.

**Freight and Delivery:** Freight is F.O.B. Albert Lea, MN. Method and route of delivery are at Streater's discretion unless Streater is furnished with complete shipping instructions at least 10 days before the scheduled ship date. Time-sensitive delivery will be handled at Streater's discretion. Quotations for time-sensitive delivery are available upon request. Freight charges will be prepaid and added to the invoice unless otherwise instructed. Streater will endeavor to ship on the requested ship date and every effort will be made to fill orders completely; however, it may be necessary at times to backorder. Streater will not be liable for any delay in the performance of any order or contract, or in the delivery of any goods, or for any damages resulting from such delay, when such delay is due to fire, riots, acts of God, strikes or other events beyond the control of Streater.

**Freight and Damage Claims:** Freight is F.O.B. Albert Lea MN. What this means is that title to the product is passed on to you when the freight carrier picks up the shipment from Streater and signs the bill of lading. Any freight damage and resultant claims are between you and the freight carrier. It is your responsibility to file a freight claim.

**Loss of Freight:** Compare the counts of the bill of lading to what you actually receive. Any exception must be noted on the carrier's delivery receipt. Failure to note any exception at this time will result in the carrier denying your claim.

**Damage of Freight:** Damage to goods received must be noted on the carrier's delivery receipt before the driver leaves the place of delivery. Ask the driver for claim forms. If the driver does not have any forms, call the carrier and request claim forms be mailed to you. Generally, if the damage to the product exceeds \$500.00, the carrier must be called for an inspection. Salvage must be held for the carrier (Very important).

**Concealed Damage:** If goods arrive in apparently good condition, but there is concealed damage, contact the carrier and ask for the goods to be inspected. Keep the product and the packaging material until they have been inspected. A claim needs to be filed with the carrier.

**Returned Goods:** No equipment may be returned without the advance written approval of an authorized Streater representative. Only stock catalog items may be returned within 60 days of original delivery and items must be in unused condition. A handling and restocking charge of 20 percent of net price will be assessed on all returns. Buyer will forward all returns to Streater freight prepaid and all items must be properly packaged.

**Warranty:** Streater warrants to original purchaser that the products it manufactures shall be free from defects in material and workmanship and will conform to applicable specifications, drawings, samples, and descriptions. This warranty shall extend for a period of one year from date of delivery to original purchaser for use. Streater, at its option, may repair or replace any products which, upon Streater's inspection, prove to be defective. Except as set forth herein:

**THERE ARE NO WARRANTIES, EXPRESS OR IMPLIED, INCLUDING THE IMPLIED WARRANTY OF MERCHANTABILITY. UNDER NO CIRCUMSTANCES SHALL STREATER BE LIABLE FOR ANY CONSEQUENTIAL DAMAGES INCURRED BY ORIGINAL PURCHASER AS A RESULT OF STREATER'S PERFORMANCE UNDER THIS ORDER.**

STANDARD COLORS	TYPE	SET UP COST	LEAD TIME	COLORS
	Metal	None	Normal	015–Decor White 0LA–Frosty White 0PP–Platinum Plus 025–Black 0KM–Dove Gray
	Wood	None	Normal	015–Decor White 0LA–Frosty White 0PP–Platinum Plus 0KM–Dove Gray
	Base Components	None	Normal	025–Black 013–Dark Bronze
	Plated Components (where indicated)	None	Normal	082–Zinc plating (satin) 081–Chrome (bright)
	Bottle Bay	None	Normal	0LA–Frosty White
OPTIONAL COLORS		\$500 for wood \$500 for metal per Purchase Order	Normal	0GX–Skyline Gray 0J8–Bright White 070–Bright Blue 0MT–Liberty Red 0KA–Charcoal 013–Dark Bronze (when not used on base components) 025–Black (wood only)
CUSTOM COLORS		As Quoted	As Quoted	Per customer request

Customer requested changes to ship dates are subject to approval by Streater. Every reasonable effort will be made to accommodate these requests without additional charges to the customer. However, customer requested move-outs within five (5) working days of the scheduled ship date will be subject to the following:

### 1. Surcharge

- A. Orders scheduled for picking, packing and loading, but not yet worked on by the warehouse:  
LTL orders (less than a full semi-trailer load) will be assessed 5% of the net selling price of the order as a handling fee - minimum \$50/maximum \$250
- B. Trailer-load sized order assessment will be determined by Vice President of Sales or Vice President of Manufacturing.
- C. Jobs picked and sitting on loading dock, but not yet loaded:
  - LTL orders will be assessed 10% of the net selling price of the order as a handling fee - minimum \$100/maximum \$500.
  - Trailer-load sized order: load trailer, invoice customer and charge customer the storage charge for each trailer.
  - For orders in process of being loaded, the assessment would be the same as the bullet above.
  - There is a 20% restocking charge if it is necessary to unload a trailer.

When heavily loading one side of your wall or gondola shelving, it is important to determine if you are creating an unbalanced load that exceeds the maximum design load (SEE LOAD CAPACITY CHART ON PAGE 106). The sample calculation below illustrates how you can determine your unbalanced load in inch-pounds.

**NOTE:** Inch-pounds are a measure of the shelf loads acting at a distance (½ shelf depth) from the standard (upright).

## SAMPLE CALCULATION

STARTER / ADD-ON UNIT TYPE USED FOR ILLUSTRATION

### CALCULATE THE UNBALANCED LOAD ACTING ON THIS STANDARD

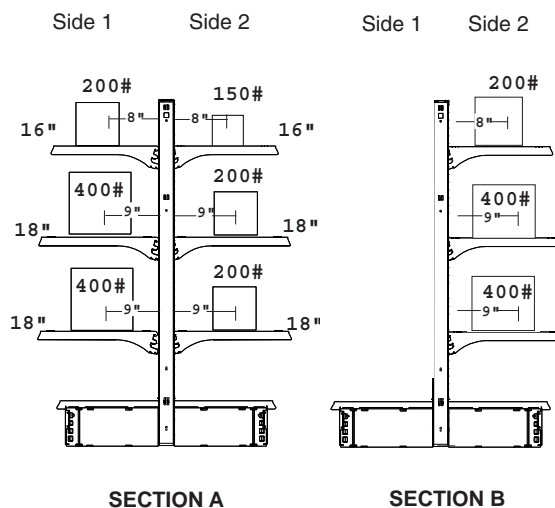
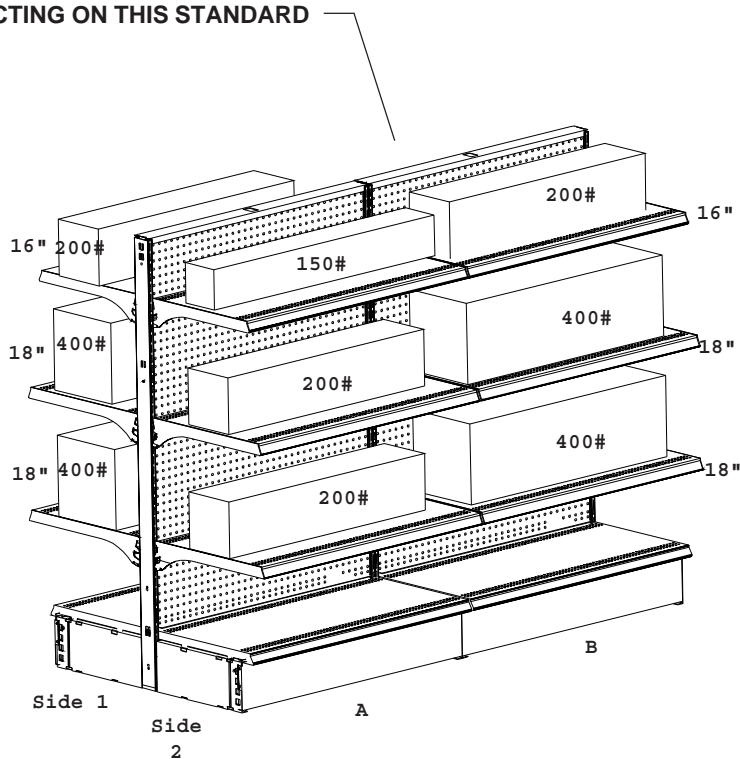

	Shelf depth , 2	x	Shelf load , 2	Side 1	Side 2
SECTION A	8"	x	100#	800"#	
	9"	x	200#	1800"#	
	9"	x	200#	1800"#	
	8"	x	75#		600"#
	9"	x	100#		900"#
	9"	x	100#		900"#
SECTION B	no load			0	
	8"	x	100#		800"#
	9"	x	200#		1800"#
	9"	x	200#		1800"#
total (Section A & B)				4400"#	6800"#

Subtract the smaller from the larger  $6800\text{"#}$   
 $- 4400\text{"#}$   
 Total unbalanced load acting on standard  $2400\text{"#}$

**NOTE:** Shelf depth is divided by 2 because an **evenly distributed shelf load** is calculated as a total load at center of shelf depth.

Shelf load is divided by 2 because a shelf load is supported by 2 standards.

Deck load does **not** contribute to unbalanced load.

UNIT TYPE 2½" Standard	INCH-POUND CAPACITY
STARTER one unit, with 2 end standards (single uprights)	3,400"#
STARTER/ADD-ON any one unit at either end of run with 1 end standard & 1 center standard (double upright)	9,500"#
STARTER/ADD-ON/FEF any end unit (1 end standard & 1 center standard) at either end of run with feature end attached	12,000"#
ADD-ON/ADD-ON any unit within a run with 2 center standards (double uprights)	12,000"#

**SPECIAL NOTES:**

- Maximum height to depth ratio is 5:1. Any situation where the height of a standard is more than 5 times the length of the bottom arm must be approved by Streater engineering department.
- The maximum unbalanced load on shelves above the joint on an extension standard (upright) should not exceed 2500 inch-pounds.
- The loads applied to perforated back panels should not exceed 150 lbs. per panel.
- Shelf locking keys increase inch-pound capacity by approximately 15%.
- Please check with Streater engineering department for verification if unfamiliar with loading conditions.

# 12 [ > ] gondola & wallcase specifications

102  
07

REV. 1.06

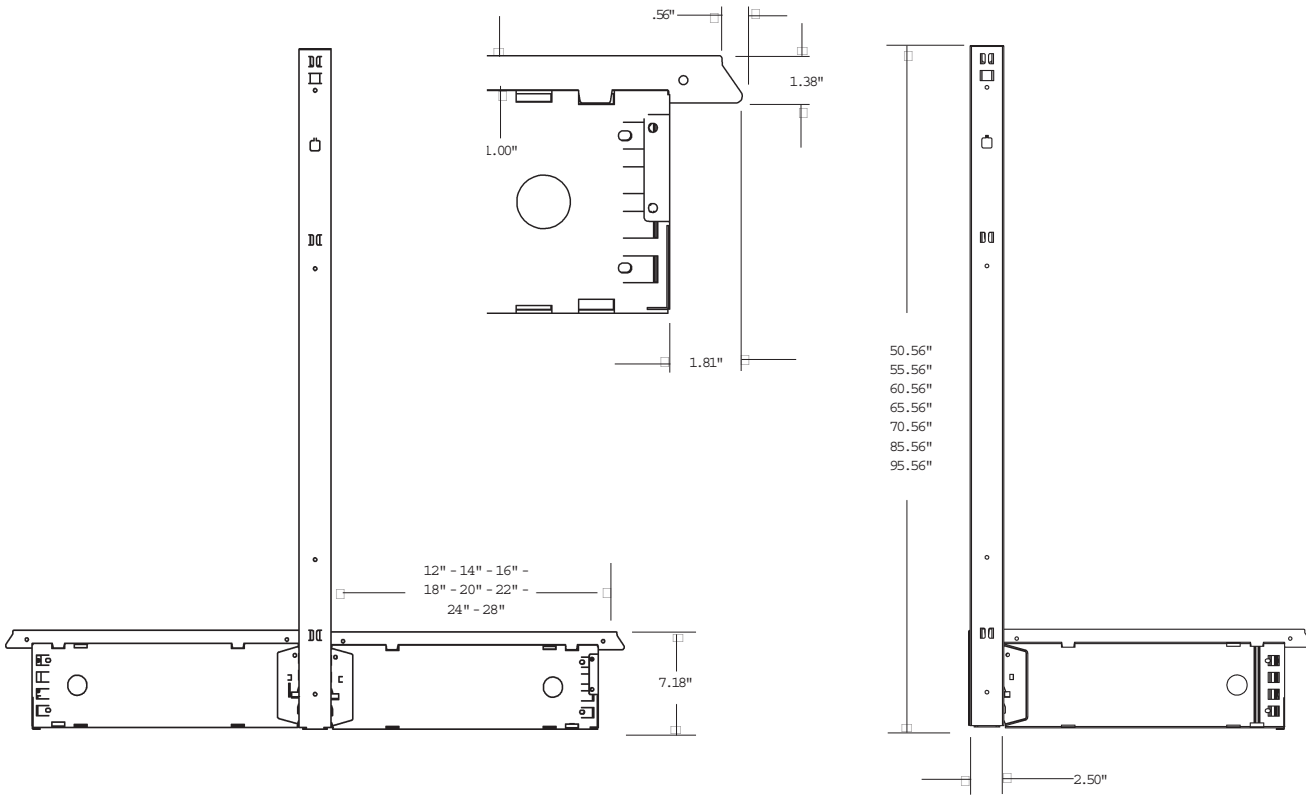

**full gondola - trimline**

**half gondola & wallcase - trimline**

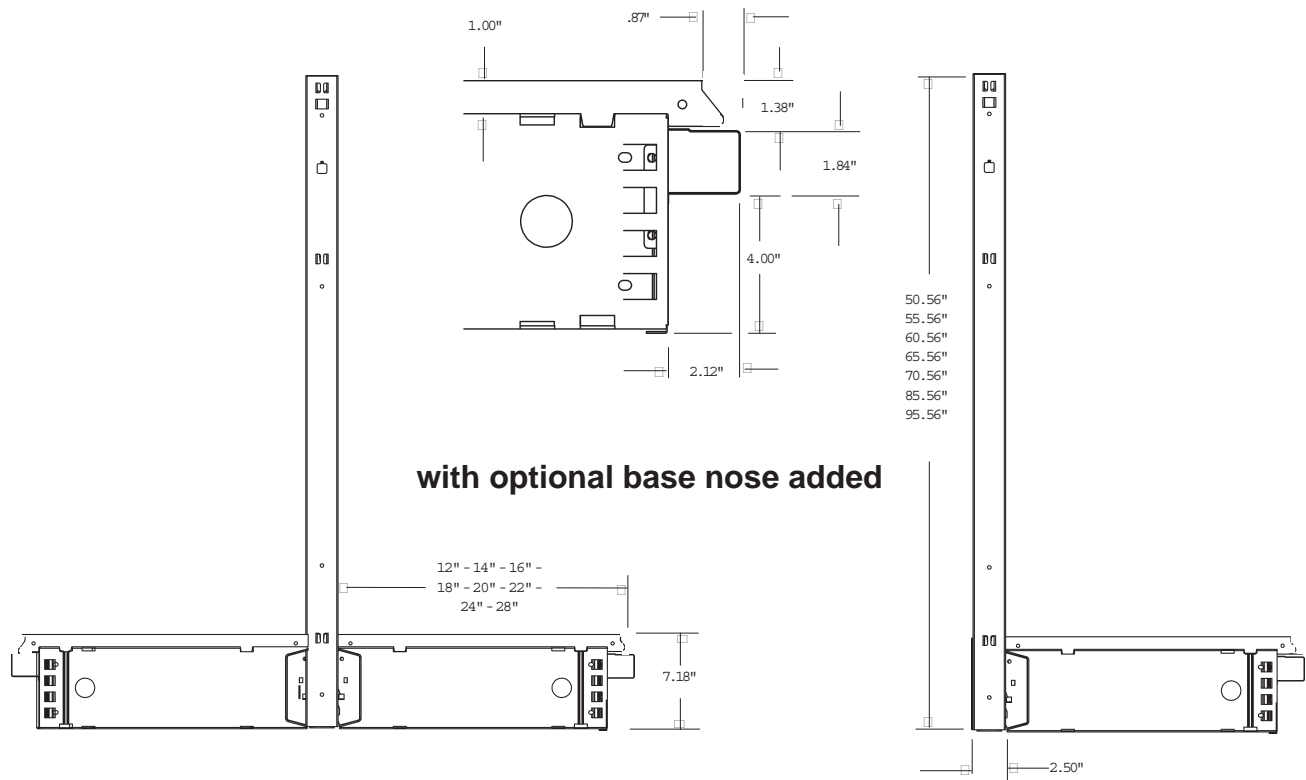

**with optional base nose added**

**full gondola - trimguard**

**half gondola & wallcase - trimguard**

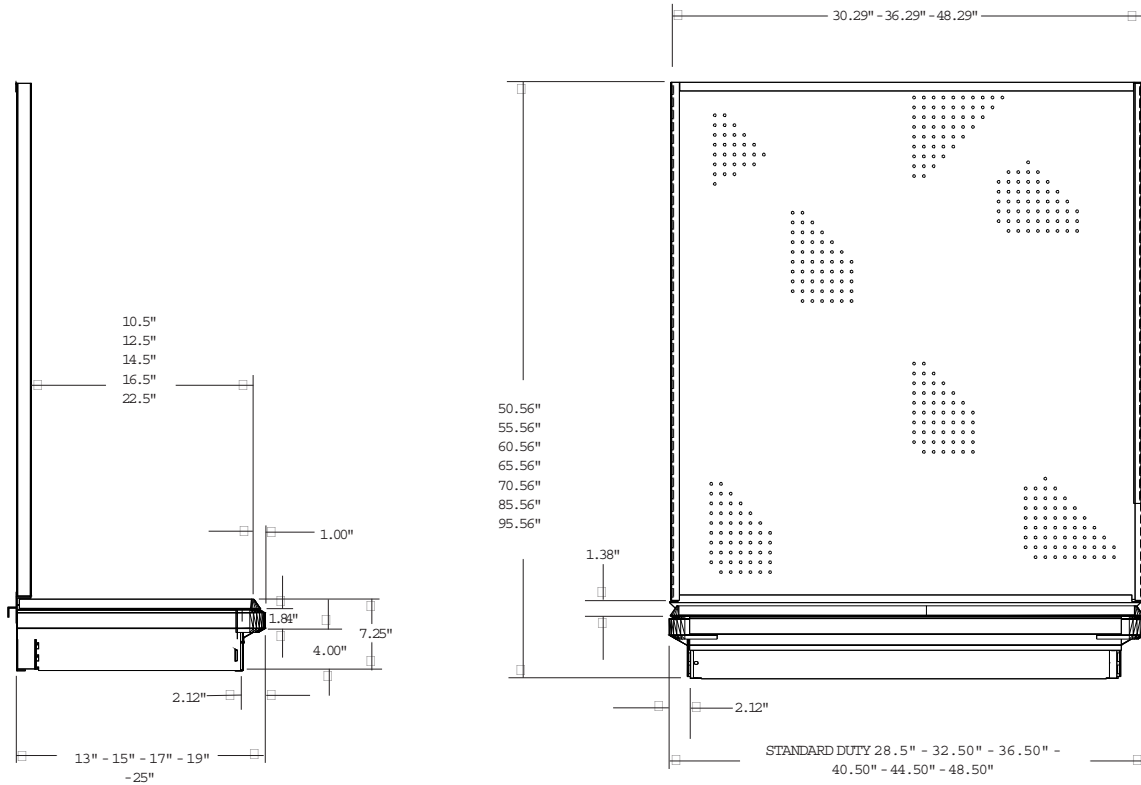

**trimguard contour end base with feature end frame**

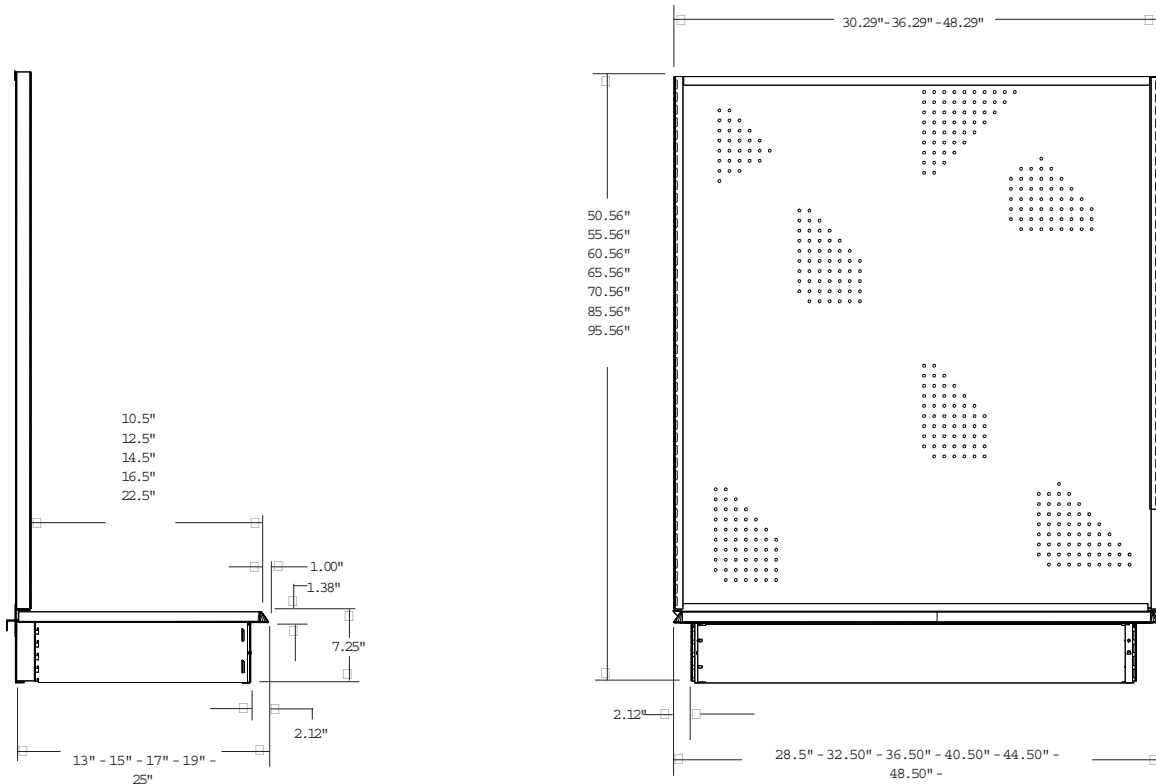

**trimline contour end base with feature end frame**

## standards

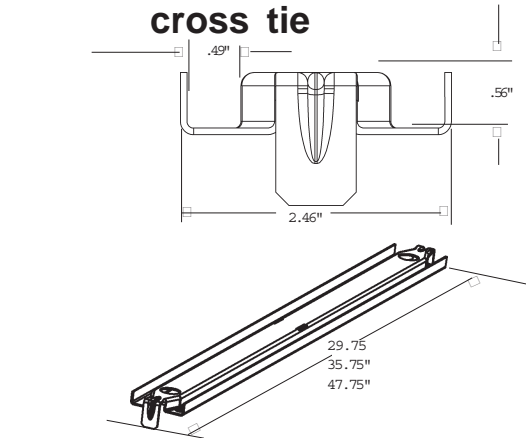
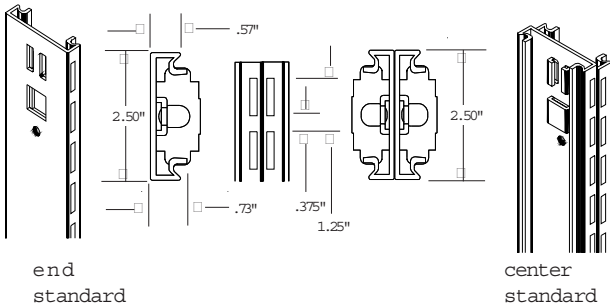

- actual heights of standards  
37½" - 50½" - 60½" - 65½" - 70½" -  
85½" - 95½"
- 12 gauge steel
- baked acrylic enamel

- 30", 36" & 48" module lengths
- kwik-fit™ - no attachment hardware required
- 16 gauge steel
- baked acrylic enamel

## top cap

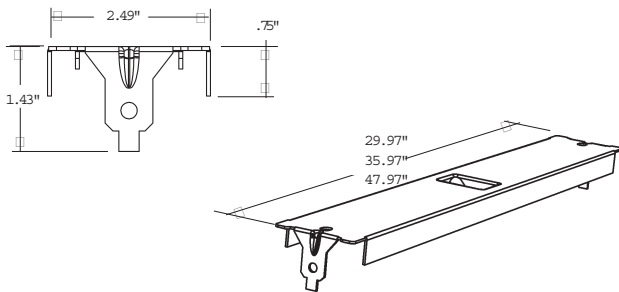

- 30", 36" & 48" module lengths
- kwik-fit™ - no attachment hardware required
- 16 gauge steel
- baked acrylic enamel
- available with electrical outlet

## end bottom arm

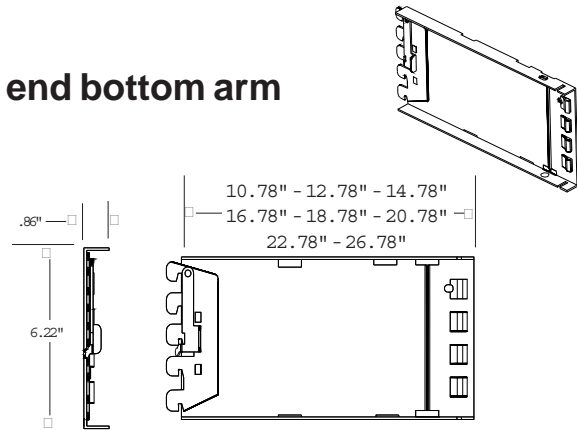

- nominal lengths 12" - 14" - 16" - 18" - 20" - 22" - 24" - 28"
- kwik-fit™ - no attachment hardware required
- 13 gauge high strength steel
- baked acrylic enamel

## tie bar

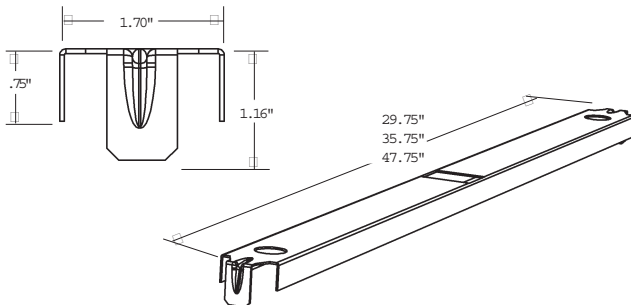

- 30", 36" & 48" module lengths
- kwik-fit™ - no attachment hardware required
- 18 gauge steel
- baked acrylic enamel

## center bottom arm

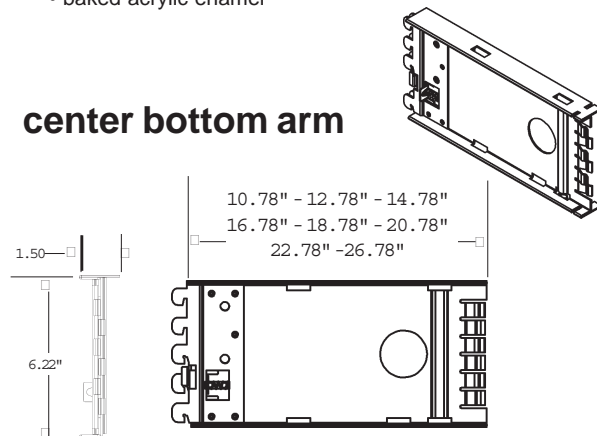

- nominal lengths 12" - 14" - 16" - 18" - 20" - 22" - 24" - 28"
- kwik-fit™ - no attachment hardware required
- 14 gauge steel with 12 gauge steel hooks
- baked acrylic enamel

### base deck

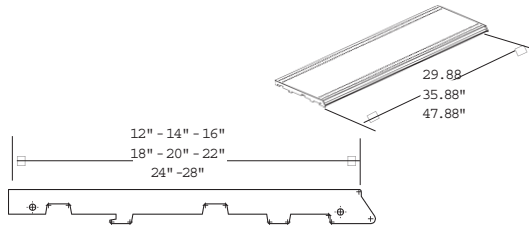

- 30", 36" & 48" module lengths
- one piece 23 gauge embossed steel deck pan with rolled-in 1 1/4" ticket moulding
- welded end plates & reinforcement hat sections
- two row perforations front & rear
- baked acrylic enamel

### trimguard base nose

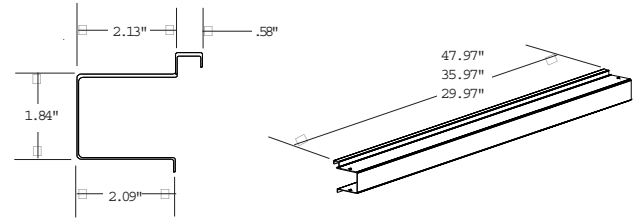

- 30", 36" & 48" module lengths
- protects front of base deck from carts, etc.
- 18 gauge steel
- baked acrylic enamel
- optional item, order as added item to trim-line gondola kits

### trimline floating kick plate

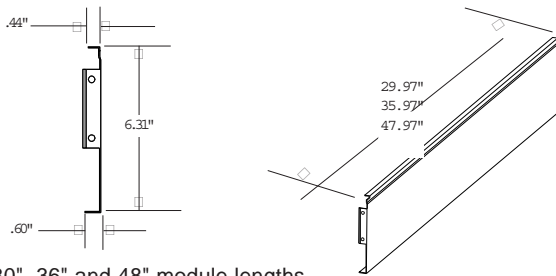

- 30", 36" and 48" module lengths
- 18 gauge steel
- baked acrylic enamel
- available with electrical knockout

### trimguard base nose end cap

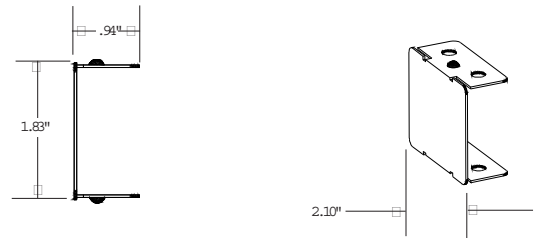

- finishes off ends of trimguard base nose
- two per half starter module & four per full starter module
- 18 gauge steel
- baked acrylic enamel
- optional item, sold individually

### nominal 1/4" back panel - finished one side

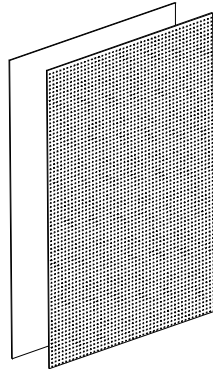

- Perforated or solid backs in choice of standard or optional color - baked enamel (see color chart for reference)

### nominal 3/4" slatwall back panel - finished one side

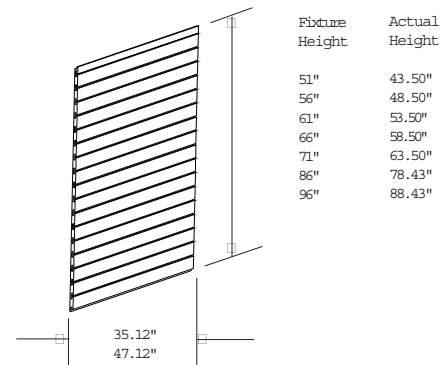

- slatwall backs in choice of standard or optional color - baked enamel (see color chart for reference)
- with or without steel T-slot inserts

## flush base

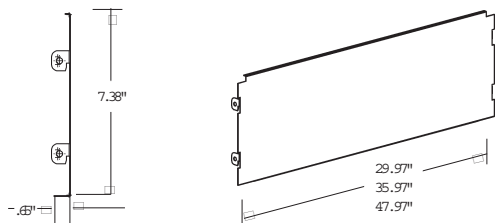

- 30", 36" - 48" module widths
- retains bottom of back panel when no base is required
- 20 gauge steel
- baked acrylic enamel

## wallcase anchoring devices

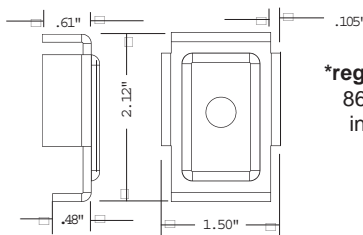

**\*regular duty(2-1/2" wallcase)**  
86" - 96" heights  
includes 2 standard wall tie  
brackets per module

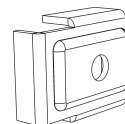

### standard wall tie bracket

- 12 gauge steel
- (82) zinc plated

## contour end base

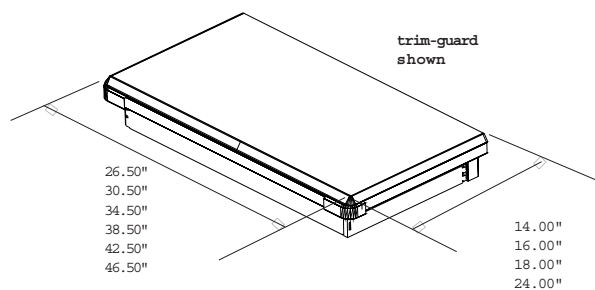

- - 14" - 16" - 18" - 24" nominal depths
- 26" thru 46" nominal widths on standard duty
- fits 14" thru 22" bases both sides
- three row perforations front and  
three row perforations rear
- baked acrylic enamel
- available in trimguard and trimline

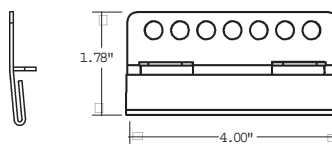

### top cap anchoring bracket

- 12 gauge steel
- (82) zinc plated

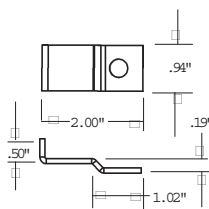
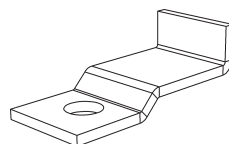
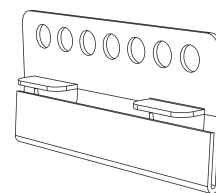

### end bottom arm tie down

- 12 gauge steel
- (82) zinc plated

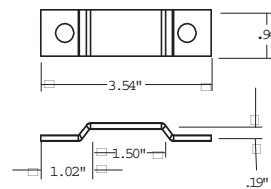
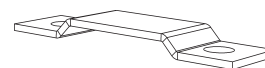

### center bottom arm tie down

- 12 gauge steel
- (82) zinc plated

## feature end frame

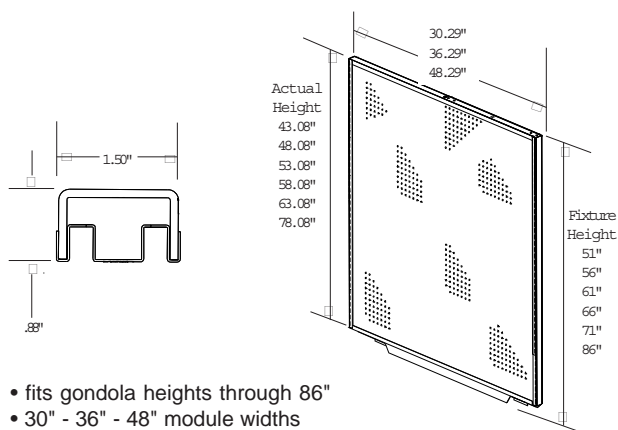

- fits gondola heights through 86"
- 30" - 36" - 48" module widths
- choice of 1/4" back panels
- support plate hooks on bottom arms
- 1-1/4" slot spacing frame, 12 gauge steel
- baked acrylic enamel